



SLA BATTERY

RA12-120 12V120AH



RA Series

RA Series Valve Regulated Lead Acid batteries are designed with AGM (Absorbent Glass Mat) technology, special thicker plates and high purity electrolyte exerts stable performance with long life and the unique 2# additive gives higher capacity than its standard which widely used in the field of UPS, telecommunications.

Application

- Alarm System
- Cable Television
- Communication Equipment
- Control Equipment
- Security System
- Medical Equipment
- UPS
- Power tools
- Emergency Power System
- Toys

General Features

- Sealed and maintenance free operation.
- Non-Spillable construction design.
- ABS containers and covers(UL94HB, UL94V-0) optional.
- Safety valve installation for explosion proof.
- High quality and high reliability.
- Exceptional deep discharge recovery performance.
- Low self discharge characteristic.
- Flexibility design for multiple install positions.

Construction

- ComponentRaw material
- PositiveLead dioxide
- NegativeLead
- ContainerABS
- CoverABS
- SealantEpoxy Resin
- Safety valveEPDR
- TerminalCopper
- SeparatorFiber glass
- ElectrolyteSulfuric acid

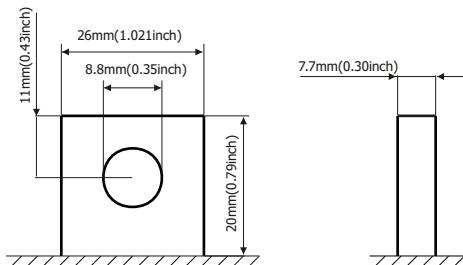

Terminal Dimensions

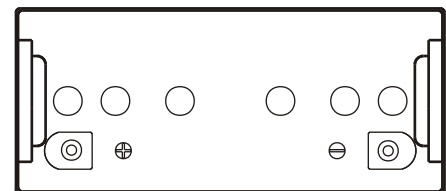
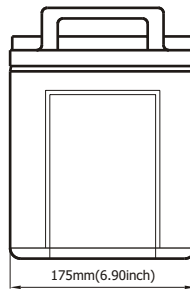
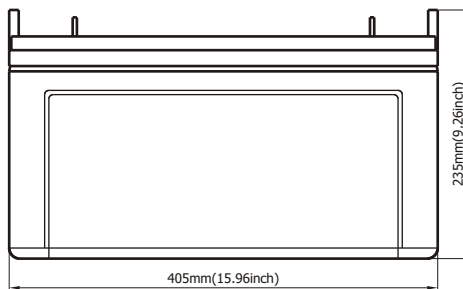

Battery Model	RA12-120			
Designed Floating Life	8 Years			
Capacity(25°C)	20HR(6.1A,1.75V)	10HR(12A,1.75V)	5HR(20.4A,1.75V)	1HR(72A,1.75V)
	122AH	120AH	102AH	72AH
Dimensions	Length	Width	Height	Total Height
	409mm(16.10inch)	175mm(6.90inch)	235mm(9.26inch)	235mm(9.26inch)
Approx. Weight	38.0Kg (83.8 lbs)			
Internal Resistance	Full charged at 25°C: 0.0041 Ohm			
Self Discharge	3% of capacity declined per month at (25°C)			
Capacity Affected by Temp.(20HR)	40°C	25°C	0°C	-15°C
	102%	100%	85%	65%
Charge Voltage(25°C)	Cycle use		Float use	
	14.4-15V(-30mV/ °C), max. Current: 30A		13.6-13.8V(-20mV/ °C)	



SLA BATTERY

RA12-120 12V120AH

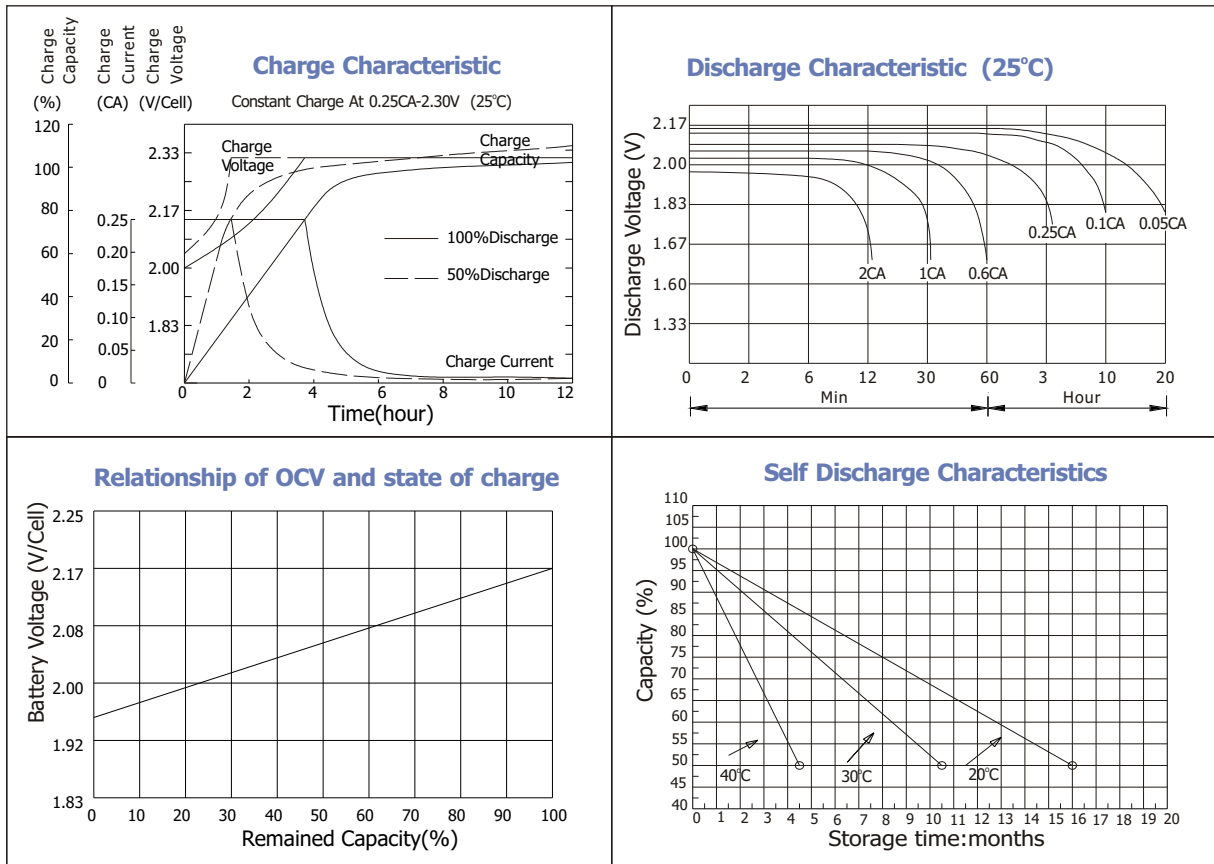

Constant current discharge ratings-amperes at 25°C

F. V/Time	5MIN	10MIN	15MIN	30MIN	1HR	3HR	5HR	10HR	20HR
1.60V	525	326	246	150	85.3	37.4	22.9	12.5	6.73
1.67V	493	310	237	144	84.2	36.0	22.4	12.3	6.50
1.70V	451	298	231	131	81.6	33.6	21.9	12.3	6.40
1.75V	442	289	224	124	77.8	32.5	21.4	12.2	6.23
1.80V	396	276	203	115	72.8	31.2	20.2	12.0	6.06
1.85V	349	263	183	106	67.8	30.1	18.9	11.8	5.89

Constant power discharge ratings-watts at 25°C

F. V/Time	5MIN	10MIN	15MIN	30MIN	1HR	3HR	5HR	10HR	20HR
1.60V	921	590	450	271	154	66.4	38.7	25.6	13.4
1.67V	888	575	444	265	153	64.3	38.5	25.4	13.0
1.70V	836	569	440	248	150	61.4	38.0	25.3	12.8
1.75V	842	567	437	241	148	60.0	37.7	25.0	12.5
1.80V	770	559	405	229	139	58.2	36.5	24.6	12.2
1.85V	698	530	367	215	131	56.5	35.3	24.3	11.7



ISO9001:2000 Certificate



G4M20206-0910-E-16



MH28539



RBRC

