



SLA BATTERY

RA6-225 6V225AH



RA Series

RA Series Valve Regulated Lead Acid batteries are designed with AGM (Absorbent Glass Mat) technology, special thicker plates and high purity electrolyte exerts stable performance with long life and the unique 2# additive gives higher capacity than its standard which widely used in the field of UPS, telecommunications.

Application

- Alarm System
- Cable Television
- Communication Equipment
- Control Equipment
- Security System
- Medical Equipment
- UPS
- Power tools
- Emergency Power System
- Toys

General Features

- Sealed and maintenance free operation.
- Non-Spillable construction design.
- ABS containers and covers(UL94HB, UL94V-0) optional.
- Safety valve installation for explosion proof.
- High quality and high reliability.
- Exceptional deep discharge recovery performance.
- Low self discharge characteristic.
- Flexibility design for multiple install positions.

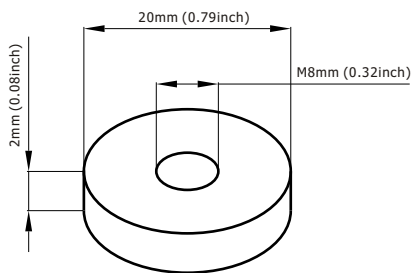

Terminal Dimensions

Construction

- ComponentRaw material
- PositiveLead dioxide
- NegativeLead
- ContainerABS
- CoverABS
- SealantEpoxy Resin
- Safety valveEPDR
- TerminalCopper
- SeparatorFiber glass
- ElectrolyteSulfuric acid

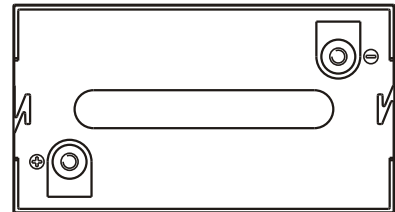
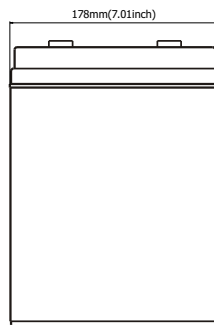
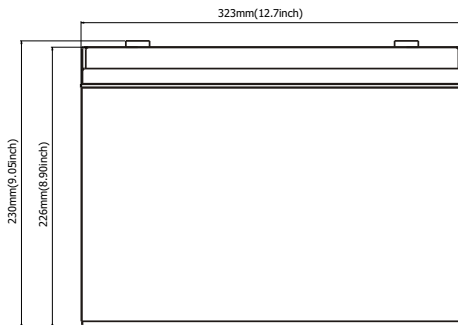

Battery Model	RA6-225			
Designed Floating Life	8 Years			
Capacity(25°C)	20HR(11.5A,1.75V)	10HR(22.5A,1.75V)	5HR(38.4A,1.75V)	1HR(135A,1.75V)
	230AH	225AH	192AH	135AH
Dimensions	Length	Width	Height	Total Height
	323mm(12.7inch)	178mm(7.01inch)	226mm(8.90inch)	230mm(9.05inch)
Approx. Weight	32Kg (70.5 lbs)			
Internal Resistance	Full charged at 25°C: 0.003 Ohm			
Self Discharge	3% of capacity declined per month at (25°C)			
Capacity Affected by Temp.(20HR)	40°C	25°C	0°C	-15°C
	102%	100%	85%	65%
Charge Voltage(25°C)	Cycle use		Float use	
	7.2-7.5V(-15mV/ °C), max. Current: 56.25A		6.8-6.9V(-10mV/ °C)	

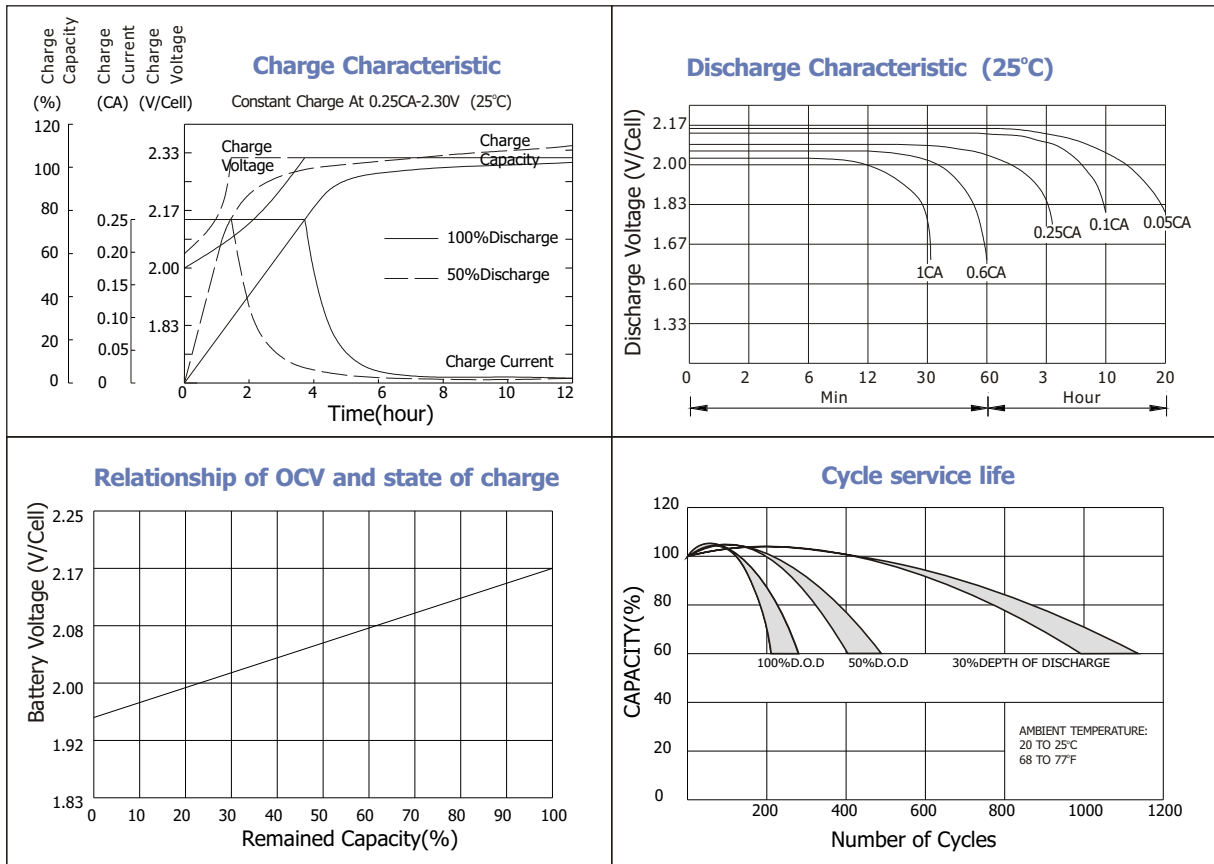

Constant current discharge ratings-amperes at 25°C

F.V/Time	5MIN	10MIN	15MIN	30MIN	1HR	3HR	5HR	10HR	20HR
1.60V	788	540	394	236	149	61.4	42.9	23.9	11.9
1.67V	709	493	383	230	148	61.2	42.6	23.5	11.8
1.70V	673	475	369	225	148	61.2	42.6	23.3	11.8
1.75V	599	439	349	221	146	60.8	42.2	22.9	11.8
1.80V	540	407	333	214	144	60.5	41.9	22.5	11.3
1.85V	410	335	288	197	143	60.3	41.5	22.1	10.7

Constant power discharge ratings-watts at 25°C

F.V/Time	5MIN	10MIN	15MIN	30MIN	1HR	3HR	5HR	10HR	20HR
1.60V	1298	896	698	446	293	118	82.1	47.7	23.7
1.67V	1231	884	691	437	283	118	82.1	47.0	23.6
1.70V	1150	862	680	425	275	118	82.1	46.6	23.6
1.75V	1071	806	639	414	273	116	81.2	45.8	23.5
1.80V	961	749	601	403	268	115	79.9	45.0	22.7
1.85V	770	621	524	369	266	114	78.8	44.2	21.3



ISO9001:2000 Certificate



G4M20206-0910-E-16



MH28539



RBRC

